

Accent boost flip table

operating instructions

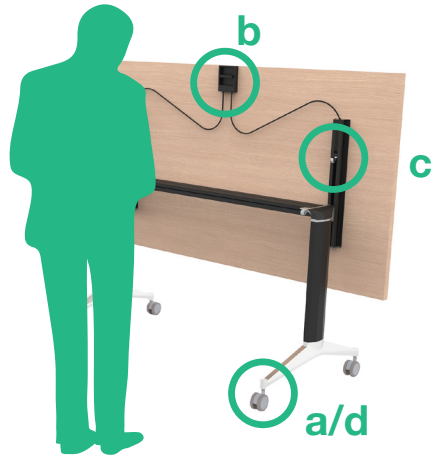

- Do not move the tables with the wheels in the locked position
- Do not stand or sit on the table
- Do not wheel the table over rough or unstable surfaces (e.g. gravel, stairs)
- These tables are rated to load weight of 50kg spread evenly across the table

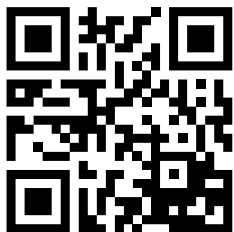

more information

visit our website
www.accentus.co.nz/instructions

unfolding the table / setting the table up

a unlocking the castor wheels



You may now move the table to the location in which you intend to use it.

b orientating the table



Facing the bottom of the table top, place one hand on the handle and squeeze that towards the edge of the table top.

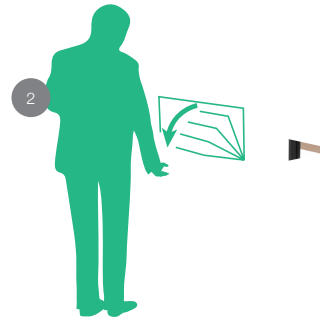

Pull the tabletop downwards you and lower it onto the frame.

c ensure the connector has clipped the topdown to the frame



Tug upwards on the table-top to check that it has clipped firmly into place and will not move.

d locking the castor wheels

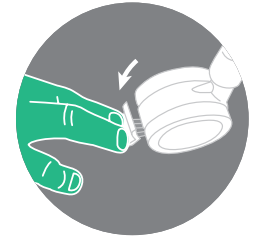

WARNING do not move the table with the wheels in the locked position

folding the table / putting the table away

a unlocking the castor wheels



You may now move the table to the location in which you intend to use it.

b unlocking the table



Face the edge of the table that has the handle, place one hand on the handle and squeeze that towards the edge of the table top.

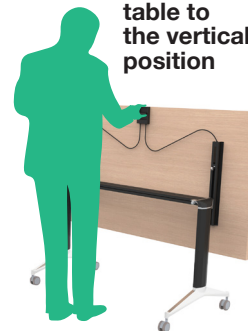

lift the table to the vertical position

You may now move the table to the location in which you intend to use it.

d locking the castor wheels

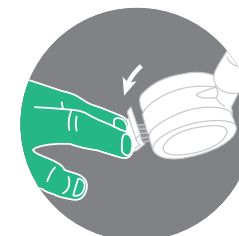

WARNING do not move the table with the wheels in the locked position

using the connectors

1

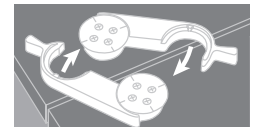

2

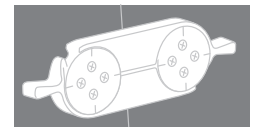

If your table has connectors, you can join two tables together to form a larger table.

In that case, each of the tables you intend to join together should have one or more connectors attached.

To join the tables that have connectors, swing the connector arms out from under the table and join them together, so they lock firmly into place. Make sure to use all connectors.

To disconnect the tables, reverse the process described above.